



523 PARK POINT DRIVE, SUITE 260
Golden, Colorado 80401



PROPERTY FEATURES

- Beautiful views
- Private offices on glass; work stations and open area
- Tall nine foot ceilings
- Glass walled conference rooms
- Kitchenette
- Easy access to downtown via I-70

PROPERTY SPECIFICATIONS

Available SF:	Suite 260 - 5,102 RSF Sublease through 4/30/21
Lease Rate:	\$17.00 FSG
Building Size:	59,773 SF
Year Built:	2000
Stories:	3
Parking Ratio:	3 reserved covered parking spaces

FOR MORE INFORMATION CONTACT:

JAMIE MACBETH

jmacbeth@gcgcre.com | 720.476.5229

RENÉE SPICER

rspicer@gcgcre.com | 720.476.5226

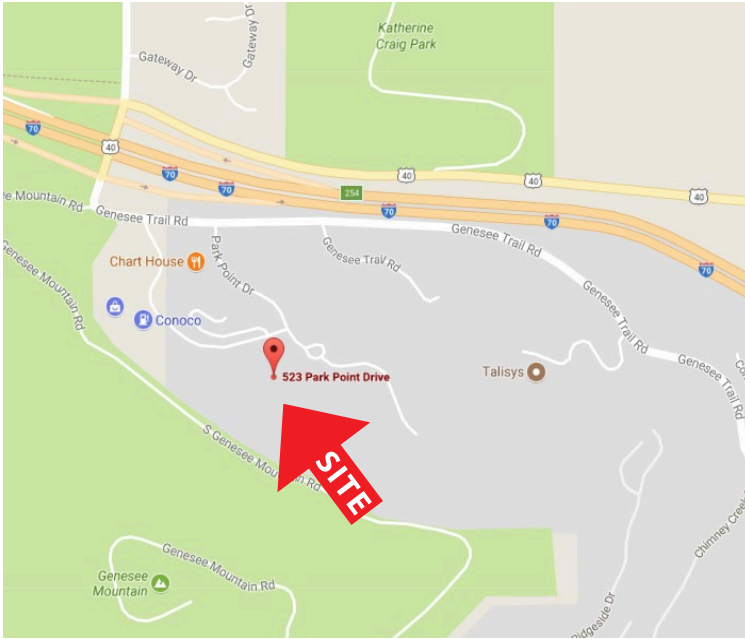

SUITE 260
5,102 RSF

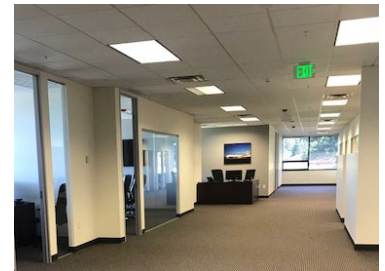

No warranty or representation is made as to the accuracy of the foregoing information. Terms of sale or lease and availability are subject to change or withdrawal without notice.

FOR MORE INFORMATION CONTACT:

JAMIE MACBETH

jmacbeth@gcgcre.com | 720.476.5229

RENÉE SPICER

rspicer@gcgcre.com | 720.476.5226