



9101 HARLAN STREET
Westminster, Colorado 80031



PROPERTY FEATURES

- Great location near Hwy 36 and Sheridan
- Retail/Restaurants close-by
- On-site property management
- Local Ownership
- City & Mountain views
- Close to RTD Park & Ride
- Common area Conference Room
- Adjacent to Westminster Mall redevelopment
- Abundant parking
- Well maintained
- Flexible Terms
- Secured access
- Proposed future site for RTD light rail stop
- Close Proximity to Denver & Boulder

PROPERTY SPECIFICATIONS

Available:	Suite 315	643 RSF
Lease Rate:		\$19.00/RSF Gross
Total Building SF:		43,000 RSF

FOR MORE INFORMATION CONTACT:

WILLIAM NETWAL

wnetwal@gcgcre.com | 720.476.5228

JAMIE MACBETH

jmacbeth@gcgcre.com | 720.476.5229



GENESEE
COMMERCIAL
GROUP, LLC

9101 HARLAN STREET
Westminster, Colorado 80031



MANAGED BY:

Blue Tee
PROPERTIES

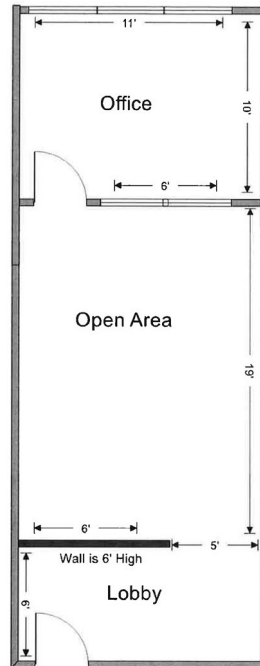

SUITE 315
643 RSF

FOR MORE INFORMATION CONTACT:

WILLIAM NETWAL

wnetwal@gcgcre.com | 720.476.5228

JAMIE MACBETH

jmacbeth@gcgcre.com | 720.476.5229

GENESEE COMMERCIAL GROUP, LLC | 710 KIPLING STREET, SUITE 403 | LAKEWOOD, COLORADO 80215 | WWW.GCGCRE.COM

No warranty or representation is made as to the accuracy of the foregoing information. Terms of sale or lease and availability are subject to change or withdrawal without notice.